

These industrial hydraulic hose reels motorized are ideal for particular application that ask strong equipment, they have a very powerful rewinding system.

They permits to use hoses with a very big diameter for fast transfer with a high delivery.



- The HYDRAULIC series is feeder by a control from an electric or motored system (the control and the central station are not included), oil pressure MAX 170 bar



- The PNEUMATIC series is feeder by a control with a direct link with the air compressed system (the control and the central station are not included), pressure MAX 6-7 bar



- The ELECTRIC series is feeder by electrical motor 12-24 V



- The MANUAL series is a valid alternative to the spring hose reels, especially when you have big quantity hoses to rewind

INDUSTRIAL HOSE REELS VARNISHED WITHOUT HOSE MOTORIZED HYDRAULIC SERIES



FOR AIR - WATER 20 bar

Equipped with:

- Swivelling joint 90° nickel-plated brass
- Viton seals

| Article | Mod. | Hose reels capacity | | Inlet-Outlet |
|--------------|--------|---------------------|-----------|--------------|
| 076-6202-600 | MI-630 | 3/4" - 45 m | 1" - 30 m | F1"G - M1"G |
| 076-6302-600 | MI-640 | 3/4" - 76 m | 1" - 46 m | F1"G - M1"G |
| 076-6402-600 | MI-650 | 3/4" - 91 m | 1" - 61 m | F1"G - M1"G |



MI-630

FOR WATER 150° C 200 bar

Equipped with:

- Swivelling joint 90° stainless steel AISI 304
- Viton seals

| Article | Mod. | Hose reels capacity | | Inlet-Outlet |
|--------------|--------|---------------------|--------------|--------------|
| 076-6204-600 | MI-630 | 3/8" - 80 m | 1/2" - 70 m | F1"G - M1"G |
| 076-6304-600 | MI-640 | 3/8" - 120 m | 1/2" - 100 m | F1"G - M1"G |
| 076-6404-600 | MI-650 | 3/8" - 160 m | 1/2" - 140 m | F1"G - M1"G |



MI-640

FOR OIL AND SIMILAR 140 bar

Equipped with:

- Swivelling joint 90° galvanized
- Polyurethane seals

| Article | Mod. | Hose reels capacity | | Inlet-Outlet |
|--------------|--------|---------------------|-----------|--------------|
| 076-6206-600 | MI-630 | 3/4" - 45 m | 1" - 30 m | F1"G - M1"G |
| 076-6306-600 | MI-640 | 3/4" - 76 m | 1" - 46 m | F1"G - M1"G |
| 076-6406-600 | MI-650 | 3/4" - 91 m | 1" - 61 m | F1"G - M1"G |



MI-650

FOR GREASE 400 bar

Equipped with:

- Swivelling joint 90° galvanized
- Polyurethane seals

| Article | Mod. | Hose reels capacity | | Inlet-Outlet |
|--------------|--------|---------------------|--------------|--------------|
| 076-6207-600 | MI-630 | 3/8" - 80 m | 1/2" - 70 m | F1"G - M1"G |
| 076-6307-600 | MI-640 | 3/8" - 120 m | 1/2" - 100 m | F1"G - M1"G |
| 076-6407-600 | MI-650 | 3/8" - 160 m | 1/2" - 140 m | F1"G - M1"G |

FOR DIESEL 10 bar

Equipped with:

- Swivelling joint 90° galvanized
- Viton seals

| Article | Mod. | Hose reels capacity | | Inlet-Outlet |
|--------------|--------|---------------------|-----------|--------------|
| 076-6208-600 | MI-630 | 3/4" - 45 m | 1" - 30 m | F1"G - M1"G |
| 076-6308-600 | MI-640 | 3/4" - 76 m | 1" - 46 m | F1"G - M1"G |
| 076-6408-600 | MI-650 | 3/4" - 91 m | 1" - 61 m | F1"G - M1"G |

OVERALL DIMENSIONS

| Mod. | A | B | C | D | E | F | G | Kg | m ³ | N ^o |
|--------|-----|-----|-----|-----|-----|-----|-----|----|----------------|----------------|
| MI-630 | 267 | 292 | 610 | 435 | 585 | 511 | 666 | 35 | 0,200 | 1 |
| MI-640 | 267 | 394 | 610 | 533 | 683 | 511 | 666 | 37 | 0,230 | 1 |
| MI-650 | 267 | 508 | 610 | 650 | 800 | 511 | 666 | 41 | 0,266 | 1 |

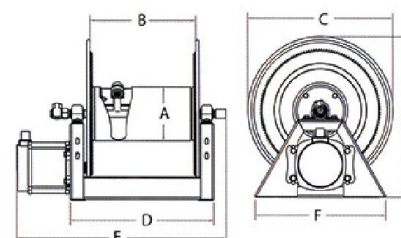



MP-630

FOR AIR - WATER 20 bar

Equipped with:

- Swivelling joint 90° nickel-plated brass
- Viton seals

| Article | Mod. | Hose reels capacity | | Inlet-Outlet |
|--------------|--------|---------------------|-----------|--------------|
| 076-7202-600 | MP-630 | 3/4" - 45 m | 1" - 30 m | F1"G - M1"G |
| 076-7302-600 | MP-640 | 3/4" - 76 m | 1" - 46 m | F1"G - M1"G |
| 076-7402-600 | MP-650 | 3/4" - 91 m | 1" - 61 m | F1"G - M1"G |

FOR WATER 150° C 200 bar

Equipped with:

- Swivelling joint 90° stainless steel AISI 304
- Viton seals

| Article | Mod. | Hose reels capacity | | Inlet-Outlet |
|--------------|--------|---------------------|--------------|--------------|
| 076-7204-600 | MP-630 | 3/8" - 80 m | 1/2" - 70 m | F1"G - M1"G |
| 076-7304-600 | MP-640 | 3/8" - 120 m | 1/2" - 100 m | F1"G - M1"G |
| 076-7404-600 | MP-650 | 3/8" - 160 m | 1/2" - 140 m | F1"G - M1"G |



MP-640

FOR OIL AND SIMILAR 140 bar

Equipped with:

- Swivelling joint 90° galvanized
- Polyurethane seals

| Article | Mod. | Hose reels capacity | | Inlet-Outlet |
|--------------|--------|---------------------|-----------|--------------|
| 076-7206-600 | MP-630 | 3/4" - 45 m | 1" - 30 m | F1"G - M1"G |
| 076-7306-600 | MP-640 | 3/4" - 76 m | 1" - 46 m | F1"G - M1"G |
| 076-7406-600 | MP-650 | 3/4" - 91 m | 1" - 61 m | F1"G - M1"G |

FOR GREASE 400 bar

Equipped with:

- Swivelling joint 90° galvanized
- Polyurethane seals

| Article | Mod. | Hose reels capacity | | Inlet-Outlet |
|--------------|--------|---------------------|--------------|--------------|
| 076-7207-600 | MP-630 | 3/8" - 80 m | 1/2" - 70 m | F1"G - M1"G |
| 076-7307-600 | MP-640 | 3/8" - 120 m | 1/2" - 100 m | F1"G - M1"G |
| 076-7407-600 | MP-650 | 3/8" - 160 m | 1/2" - 140 m | F1"G - M1"G |



MP-650



FOR DIESEL 10 bar

Equipped with:

- Swivelling joint 90° galvanized
- Viton seals

| Article | Mod. | Hose reels capacity | | Inlet-Outlet |
|--------------|--------|---------------------|-----------|--------------|
| 076-7208-600 | MP-630 | 3/4" - 45 m | 1" - 30 m | F1"G - M1"G |
| 076-7308-600 | MP-640 | 3/4" - 76 m | 1" - 46 m | F1"G - M1"G |
| 076-7408-600 | MP-650 | 3/4" - 91 m | 1" - 61 m | F1"G - M1"G |

OVERALL DIMENSIONS

| Mod. | A | B | C | D | E | F | G |  |  |  |
|--------|-----|-----|-----|-----|-----|-----|-----|---|---|---|
| MP-630 | 267 | 292 | 610 | 435 | 635 | 511 | 666 | 36 | 0,200 | 1 |
| MP-640 | 267 | 394 | 610 | 533 | 733 | 511 | 666 | 38 | 0,230 | 1 |
| MP-650 | 267 | 508 | 610 | 650 | 850 | 511 | 666 | 42 | 0,266 | 1 |

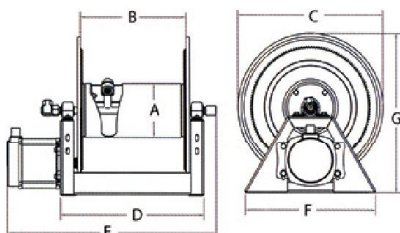

FOR AIR - WATER 20 bar

Equipped with:

- Swivelling joint 90° nickel-plated brass
- Viton seals

| Article | Mod. | Hose reels capacity | | Inlet-Outlet |
|--------------|--------|---------------------|-----------|--------------|
| 076-8212-600 | ME-630 | 3/4" - 45 m | 1" - 30 m | F1"G - M1"G |
| 076-8312-600 | ME-640 | 3/4" - 76 m | 1" - 46 m | F1"G - M1"G |
| 076-8412-600 | ME-650 | 3/4" - 91 m | 1" - 61 m | F1"G - M1"G |



ME-630

FOR WATER 150° C 200 bar

Equipped with:

- Swivelling joint 90° stainless steel AISI 304
- Viton seals

| Article | Mod. | Hose reels capacity | | Inlet-Outlet |
|--------------|--------|---------------------|--------------|--------------|
| 076-8214-600 | ME-630 | 3/8" - 80 m | 1/2" - 70 m | F1"G - M1"G |
| 076-8314-600 | ME-640 | 3/8" - 120 m | 1/2" - 100 m | F1"G - M1"G |
| 076-8414-600 | ME-650 | 3/8" - 160 m | 1/2" - 140 m | F1"G - M1"G |



ME-640

FOR OIL AND SIMILAR 140 bar

Equipped with:

- Swivelling joint 90° galvanized
- Polyurethane seals

| Article | Mod. | Hose reels capacity | | Inlet-Outlet |
|--------------|--------|---------------------|-----------|--------------|
| 076-8216-600 | ME-630 | 3/4" - 45 m | 1" - 30 m | F1"G - M1"G |
| 076-8316-600 | ME-640 | 3/4" - 76 m | 1" - 46 m | F1"G - M1"G |
| 076-8416-600 | ME-650 | 3/4" - 91 m | 1" - 61 m | F1"G - M1"G |

FOR GREASE 400 bar

Equipped with:

- Swivelling joint 90° galvanized
- Polyurethane seals

| Article | Mod. | Hose reels capacity | | Inlet-Outlet |
|--------------|--------|---------------------|--------------|--------------|
| 076-8217-600 | ME-630 | 3/8" - 80 m | 1/2" - 70 m | F1"G - M1"G |
| 076-8317-600 | ME-640 | 3/8" - 120 m | 1/2" - 100 m | F1"G - M1"G |
| 076-8417-600 | ME-650 | 3/8" - 160 m | 1/2" - 140 m | F1"G - M1"G |



ME-650

FOR DIESEL 10 bar

Equipped with:

- Swivelling joint 90° galvanized
- Viton seals

| Article | Mod. | Hose reels capacity | | Inlet-Outlet |
|--------------|--------|---------------------|-----------|--------------|
| 076-8218-600 | ME-630 | 3/4" - 45 m | 1" - 30 m | F1"G - M1"G |
| 076-8318-600 | ME-640 | 3/4" - 76 m | 1" - 46 m | F1"G - M1"G |
| 076-8418-600 | ME-650 | 3/4" - 91 m | 1" - 61 m | F1"G - M1"G |

OVERALL DIMENSIONS

| Mod. | A | B | C | D | E | F | G |  Kg |  m³ |  No. |
|--------|-----|-----|-----|-----|-----|-----|-----|--|--|---|
| ME-630 | 267 | 292 | 610 | 435 | 615 | 511 | 666 | 38 | 0,200 | 1 |
| ME-640 | 267 | 394 | 610 | 533 | 713 | 511 | 666 | 41 | 0,230 | 1 |
| ME-650 | 267 | 508 | 610 | 650 | 830 | 511 | 666 | 45 | 0,266 | 1 |

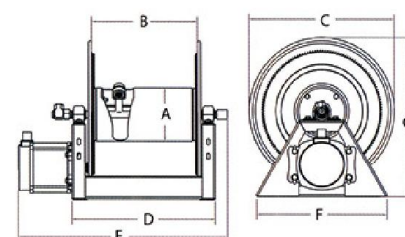

HOSE REELS



ME-630

FOR AIR - WATER 20 bar

Equipped with:

- Swivelling joint 90° nickel-plated brass
- Viton seals

| Article | Mod. | Hose reels capacity | | Inlet-Outlet |
|--------------|--------|---------------------|-----------|--------------|
| 076-8222-600 | ME-630 | 3/4" - 45 m | 1" - 30 m | F1"G - M1"G |
| 076-8322-600 | ME-640 | 3/4" - 76 m | 1" - 46 m | F1"G - M1"G |
| 076-8422-600 | ME-650 | 3/4" - 91 m | 1" - 61 m | F1"G - M1"G |



ME-640

FOR WATER 150° C 200 bar

Equipped with:

- Swivelling joint 90° stainless steel AISI 304
- Viton seals

| Article | Mod. | Hose reels capacity | | Inlet-Outlet |
|--------------|--------|---------------------|--------------|--------------|
| 076-8224-600 | ME-630 | 3/8" - 80 m | 1/2" - 70 m | F1"G - M1"G |
| 076-8324-600 | ME-640 | 3/8" - 120 m | 1/2" - 100 m | F1"G - M1"G |
| 076-8424-600 | ME-650 | 3/8" - 160 m | 1/2" - 140 m | F1"G - M1"G |

FOR OIL AND SIMILAR 140 bar

Equipped with:

- Swivelling joint 90° galvanized
- Polyurethane seals

| Article | Mod. | Hose reels capacity | | Inlet-Outlet |
|--------------|--------|---------------------|-----------|--------------|
| 076-8226-600 | ME-630 | 3/4" - 45 m | 1" - 30 m | F1"G - M1"G |
| 076-8326-600 | ME-640 | 3/4" - 76 m | 1" - 46 m | F1"G - M1"G |
| 076-8426-600 | ME-650 | 3/4" - 91 m | 1" - 61 m | F1"G - M1"G |



ME-650

FOR GREASE 400 bar

Equipped with:

- Swivelling joint 90° galvanized
- Polyurethane seals

| Article | Mod. | Hose reels capacity | | Inlet-Outlet |
|--------------|--------|---------------------|--------------|--------------|
| 076-8227-600 | ME-630 | 3/8" - 80 m | 1/2" - 70 m | F1"G - M1"G |
| 076-8327-600 | ME-640 | 3/8" - 120 m | 1/2" - 100 m | F1"G - M1"G |
| 076-8427-600 | ME-650 | 3/8" - 160 m | 1/2" - 140 m | F1"G - M1"G |

FOR DIESEL 10 bar



Equipped with:

- Swivelling joint 90° galvanized
- Viton seals

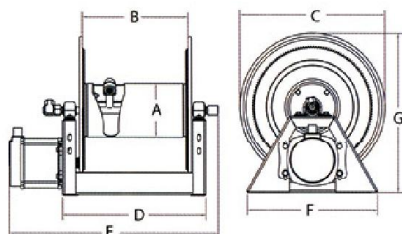
| Article | Mod. | Hose reels capacity | | Inlet-Outlet |
|--------------|--------|---------------------|-----------|--------------|
| 076-8228-600 | ME-630 | 3/4" - 45 m | 1" - 30 m | F1"G - M1"G |
| 076-8328-600 | ME-640 | 3/4" - 76 m | 1" - 46 m | F1"G - M1"G |
| 076-8428-600 | ME-650 | 3/4" - 91 m | 1" - 61 m | F1"G - M1"G |



OVERALL DIMENSIONS

| Mod. | A | B | C | D | E | F | G |  |  |  |
|--------|-----|-----|-----|-----|-----|-----|-----|---|---|---|
| ME-630 | 267 | 292 | 610 | 435 | 615 | 511 | 666 | 42 | 0.200 | 1 |
| ME-640 | 267 | 394 | 610 | 533 | 713 | 511 | 666 | 44 | 0.230 | 1 |
| ME-650 | 267 | 508 | 610 | 650 | 830 | 511 | 666 | 48 | 0.266 | 1 |

FOR AIR - WATER 20 bar

Equipped with:

- Swivelling joint 90° nickel-plated brass
- Viton seals

| Article | Mod. | Hose reels capacity | | Inlet-Outlet |
|--------------|-------|---------------------|-----------|--------------|
| 077-9202-600 | H-630 | 3/4" - 45 m | 1" - 30 m | F1"G - M1"G |
| 077-9302-600 | H-640 | 3/4" - 76 m | 1" - 46 m | F1"G - M1"G |
| 077-9402-600 | H-650 | 3/4" - 91 m | 1" - 61 m | F1"G - M1"G |



H-630

FOR WATER 150° C 200 bar

Equipped with:

- Swivelling joint 90° stainless steel AISI 304
- Viton seals

| Article | Mod. | Hose reels capacity | | Inlet-Outlet |
|--------------|-------|---------------------|--------------|--------------|
| 077-9204-600 | H-630 | 3/8" - 80 m | 1/2" - 70 m | F1"G - M1"G |
| 077-9304-600 | H-640 | 3/8" - 120 m | 1/2" - 100 m | F1"G - M1"G |
| 077-9404-600 | H-650 | 3/8" - 160 m | 1/2" - 140 m | F1"G - M1"G |



H-640

FOR OIL AND SIMILAR 140 bar

Equipped with:

- Swivelling joint 90° galvanized
- Polyurethane seals

| Article | Mod. | Hose reels capacity | | Inlet-Outlet |
|--------------|-------|---------------------|-----------|--------------|
| 077-9206-600 | H-630 | 3/4" - 45 m | 1" - 30 m | F1"G - M1"G |
| 077-9306-600 | H-640 | 3/4" - 76 m | 1" - 46 m | F1"G - M1"G |
| 077-9406-600 | H-650 | 3/4" - 91 m | 1" - 61 m | F1"G - M1"G |



H-650

FOR DIESEL 10 bar

Equipped with:

- Swivelling joint 90° galvanized
- Viton seals

| Article | Mod. | Hose reels capacity | | Inlet-Outlet |
|--------------|-------|---------------------|-----------|--------------|
| 077-9208-600 | H-630 | 3/4" - 45 m | 1" - 30 m | F1"G - M1"G |
| 077-9308-600 | H-640 | 3/4" - 76 m | 1" - 46 m | F1"G - M1"G |
| 077-9408-600 | H-650 | 3/4" - 91 m | 1" - 61 m | F1"G - M1"G |

OVERALL DIMENSIONS

| Mod. | A | B | C | D | E | F | G | Kg | m ³ | N ^o |
|-------|-----|-----|-----|-----|-----|-----|-----|----|----------------|----------------|
| H-630 | 267 | 292 | 610 | 435 | 725 | 511 | 666 | 34 | 0,200 | 1 |
| H-640 | 267 | 394 | 610 | 533 | 823 | 511 | 666 | 36 | 0,230 | 1 |
| H-650 | 267 | 508 | 610 | 650 | 940 | 511 | 666 | 40 | 0,266 | 1 |

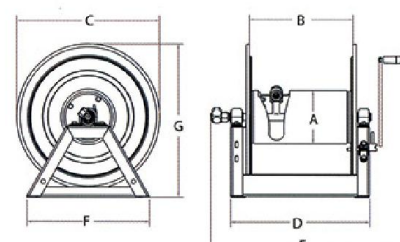

The MANUAL hose reels are a valid alternative to the spring hose reels especially when you have big quantity hoses to rewind.